

Specification for **SCS** Clamp Ferrite 9031 for low and medium frequency

A Mechanische Abmessungen / dimensions:

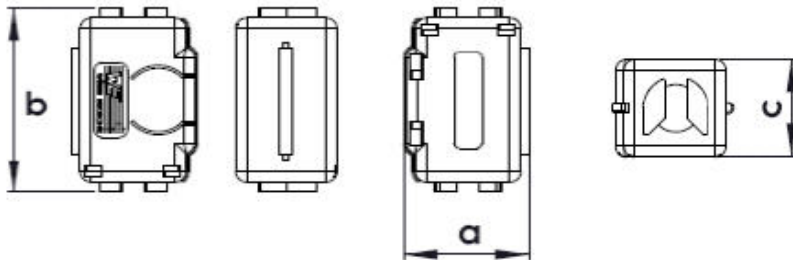

a	21,7 typ.	mm
b	35,1 typ.	mm
c	18,2 typ.	mm
für Kabeldurchmesser / for cable diameter		
Ø	4,5 - 8	mm

B Elektrische Eigenschaften / electrical properties:

Eigenschaften / properties	Testbedingungen / test conditions		Wert / value	Einheit / unit	Tol.
Impedanz @ 1 Wg./ impedance @ 1 turn	1 MHz	Z	30	Ω	min.
Impedanz @ 1 Wg./ impedance @ 1 turn	10 MHz	Z	45	Ω	min.
Impedanz @ 2 Wg./ impedance @ 2 turn		Z		Ω	
Impedanz @ 2 Wg./ impedance @ 2 turn		Z		Ω	

C



D Prüfgeräte / test equipment:

E4991A für/for Z und/and material	
16092A - Klemme / clamp	
AWG26 - Ø 0,5mm - Länge/length:	165 mm

E Testbedingungen / test conditions:

Luftfeuchtigkeit / humidity:	33%
Umgebungstemperatur / temperature:	+ 20°C

F Werkstoffe & Zulassungen / material & approvals:

Basismaterial / base material:	8 W 5000
Kunststoff / plastic material:	PA 66 / 6
UL-Zulassungen / UL-approval:	UL94-V0 / E53898
Farbe / colour:	elektrograu / electronic grey

G Eigenschaften / general specifications:

Curietemperatur / curie temperature:	+ 160°C
Gewicht / weight:	29,0g typ.
Lagertemperatur / storage temperature:	-40°C ~ + 85°C
Betriebstemp. / operating temperature:	-25°C ~ +105°C

H Impedanzverlauf / impedance curve:

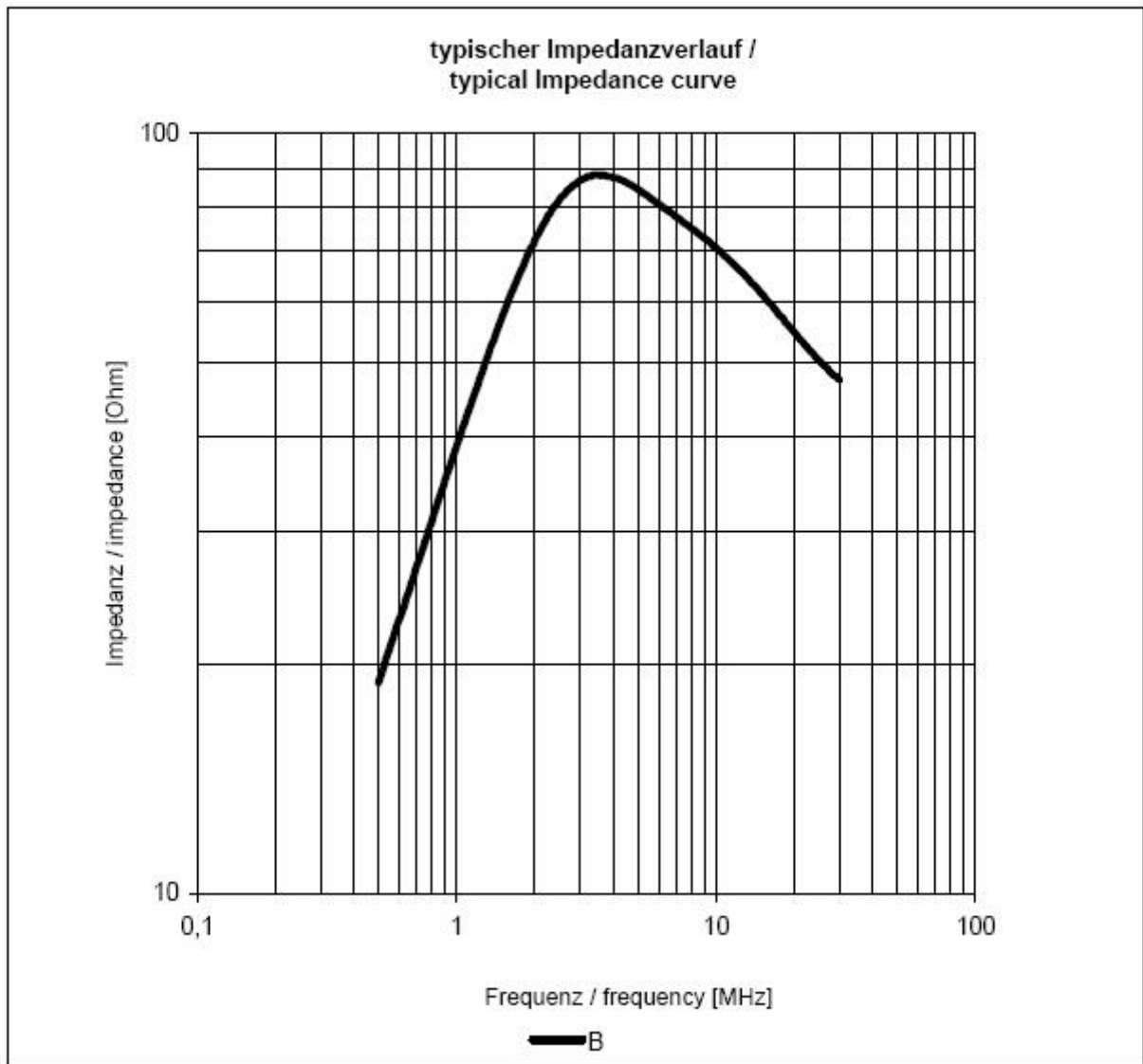

B: 1 x durch Bohrung Ferrit / 1 x times trough ferrite